

# Barred Owl Nest Box Plans



Schlitz Audubon  
Nature Center

## Barred Owl | *Stix varia*

- Size:** 20-24"
- Wingspan:** 42"
- Eggs:** 2-3
- Incubation:** 28-33 days
- Fledge:** 42-44 days
- Diet:** Mammals: mice, voles; small birds, frogs, lizards, fish, crayfish, salamanders
- Habitat:** Coniferous, hardwood, wetlands; hunt in open
- Distribution:** North America east of the Rockies
- Fun Facts:** "Who cooks for you. Who cooks for you all" call can be put to that phrase. Young may stay with adults up to 4 months after leaving the nest.



**Nest box placement:** Space half a mile from each other 20-30 feet high. Clean out or place box in January within 200 feet of water in hardwood area.

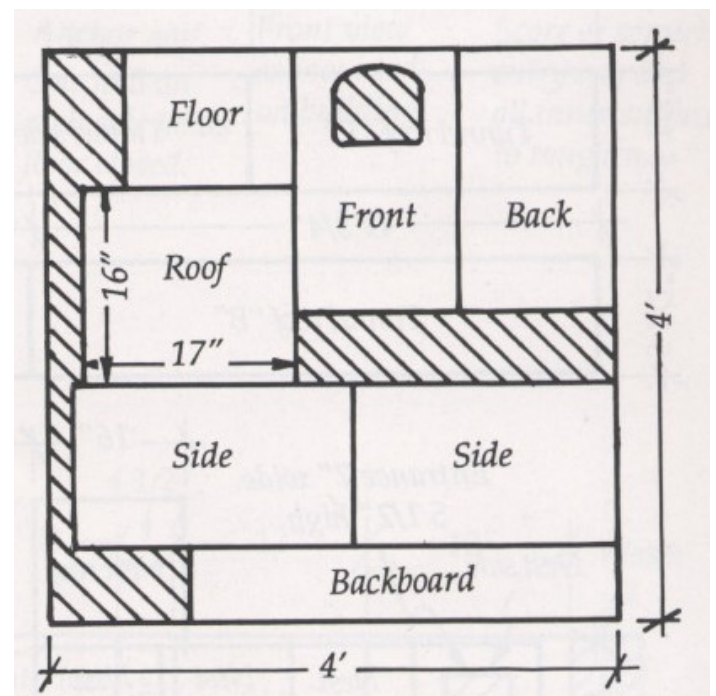
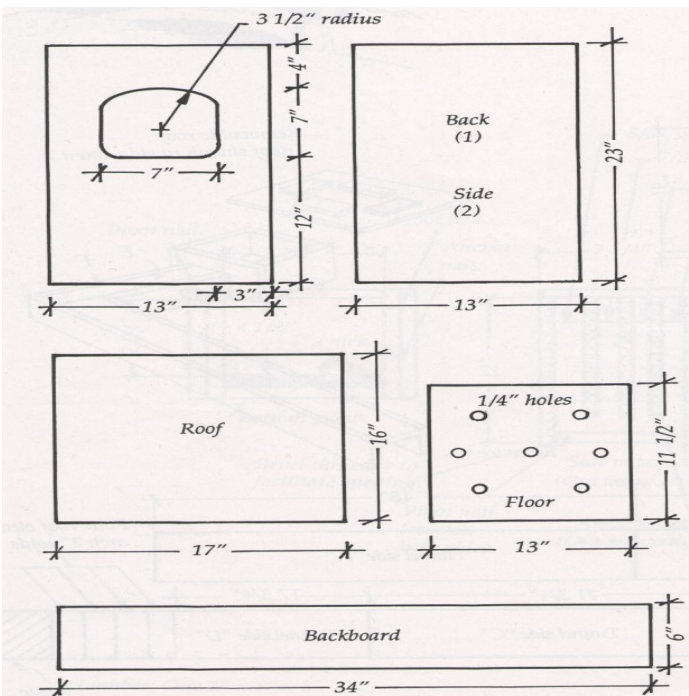

**Lumber:** One 4' x 4' x 3/4" sheet exterior plywood.

Copyright 1992 Minnesota Department of Natural Resources